

EZY Jamb Symbol Library Usage Instructions

Overview of the EZY Jamb Symbol Library:

The EZY Jamb Symbol Library was created to allow a designer to simulate real-time usage of the EZY Jamb products. Both plan and elevation views are provided in a dynamic environment. The use of "Dynamic Blocks" within the library allows for each symbol to emulate its' real-life equivalent meaning that each symbol can be placed and then sized according to each individual situation. Each plan symbol's minimum and maximum size is based on the values provided in the catalog.

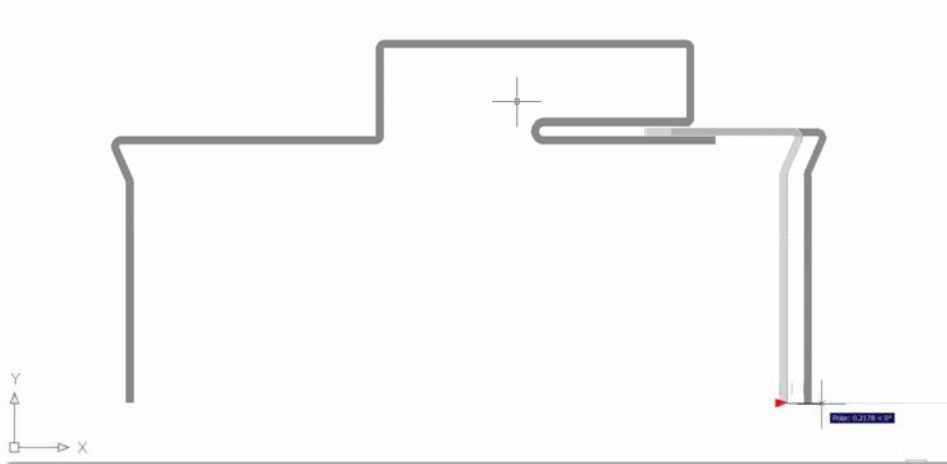

Figure 1: AutoCAD Image showing "Section A & RA20" block

SECTION A COMBINATIONS	FINISHED THICKNESS WALL TOLERANCES		SECTION C COMBINATIONS	FINISHED THICKNESS WALL TOLERANCES	
	MAX. IN.	MIN. IN.		MAX. IN.	MIN. IN.
SECTION A & RA20	3-1/2"	3-3/8"	SECTION C & RA20	3-7/8"	3-1/2"
SECTION A & RA25	3-11/16"	3-3/8"	SECTION C & RA25	4"	3-5/8"
SECTION A & RA35	3-15/16"	3-9/16"	SECTION C & RA35	4-3/8"	4"
SECTION A & RA50	4-9/16"	4-3/16"	SECTION C & RA50	4-7/8"	4-1/2"
SECTION A & RA60	4-15/16"	4-9/16"	SECTION C & RA60	5-3/8"	5"
SECTION A & RA65	5-1/8"	4-3/4"	SECTION C & RA65	5-1/2"	5-1/8"
SECTION A & RA90	6-1/8"	5-3/4"	SECTION C & RA90	6-1/2"	6"
SECTION A & RA100	6-1/2"	6-1/8"	SECTION C & RA100	6-7/8"	6-1/2"
SECTION A & RA120	7-5/16"	6-15/16"	SECTION C & RA120	7-3/4"	7-3/8"
SECTION A & RA150	8-1/2"	8-1/8"	SECTION C & RA150	8-7/8"	8-1/2"

Figure 2: Excerpt from EZY Jamb Specification document showing Min. and Max. values

The elevation views are created in a way that each view, "Section A" & "Section C", can be dynamically stretched both in width and in height.

Section A Elevation Details:

Min. Width 3-3/8"
Max. Width 8-1/2"
Min. Height 6'
Max. Height 11'

Section C Elevation Details:

Min. Width 3-1/2"
Max. Width 8-7/8"
Min. Height 6'
Max. Height 11'

Using the EZY Jamb Symbol Library:

1. Start AutoCAD.
2. Create a new drawing, or open an existing drawing.
3. If the tool palette is not displayed, go to the "Tools" pull down, select the "Palettes" flyout and click on "Tool Palettes".

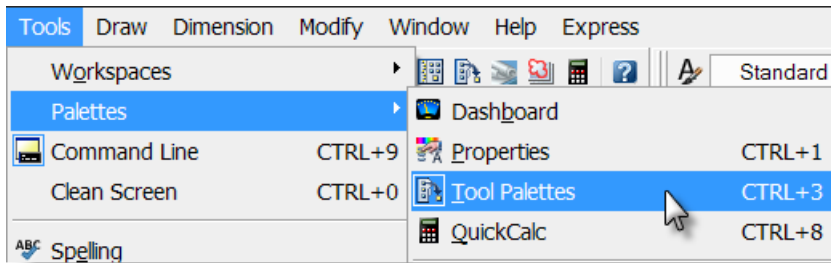

(If the "EZY Jamb Symbols" palette is not loaded, please refer to the document titled "EZY Jamb Symbol Library Loading Instructions.doc" for detailed instructions on loading the symbols.)

4. Select the symbol you would like to insert from the tool palette. For this example we will be inserting the "Section A & RA50" plan view.

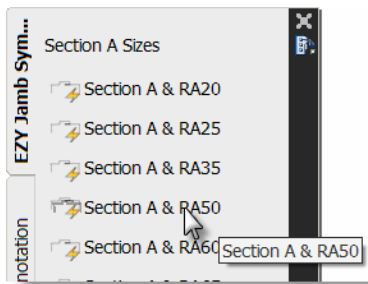

5. The insertion point for all plan views is the upper inside corner of the block. This would correspond to the top left edge of the wall section. Place the symbol in the appropriate section using AutoCAD Object Snaps for proper placement.

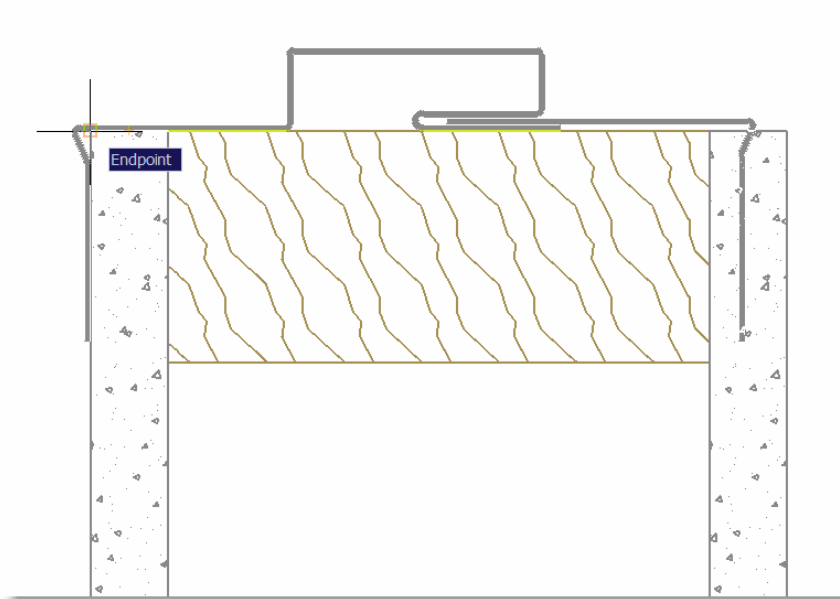

6. Once the symbol is placed, select the symbol to display the dynamic icon.

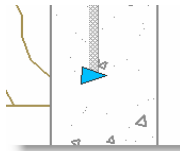

7. To dynamically stretch the symbol, click on the dynamic symbol and pull the symbol to the desired width. Left click once the desired width is located. If the desired width is not available, erase the symbol and try inserting the next larger size. Hit the "Esc" key to deselect the symbol.

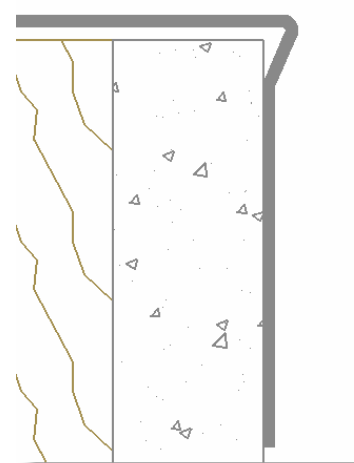
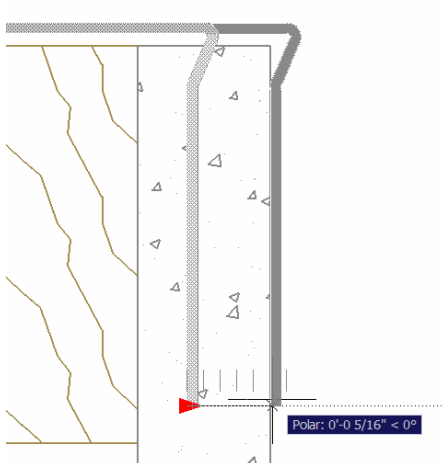

8. For Elevation views, follow the same procedure for adjusting the width and/or height of the symbols.



Figure 3: Adjusting Elevation Width

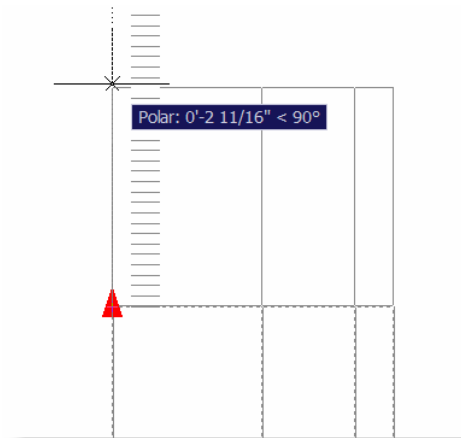

Figure 4: Adjusting Elevation Height